

- 1 Visitor/ Employee Parking
- 2 Visitor Parking
- 3 Emergency Room Walk-In Entrance
- 4 Marian Medical Professional Building Parking
- 5 Marian Medical Professional Building
- 6 Parking Lot A
- 7 St. Elizabeth College of Nursing
- 8 Parking Lot B
- 9 Parking Lot C

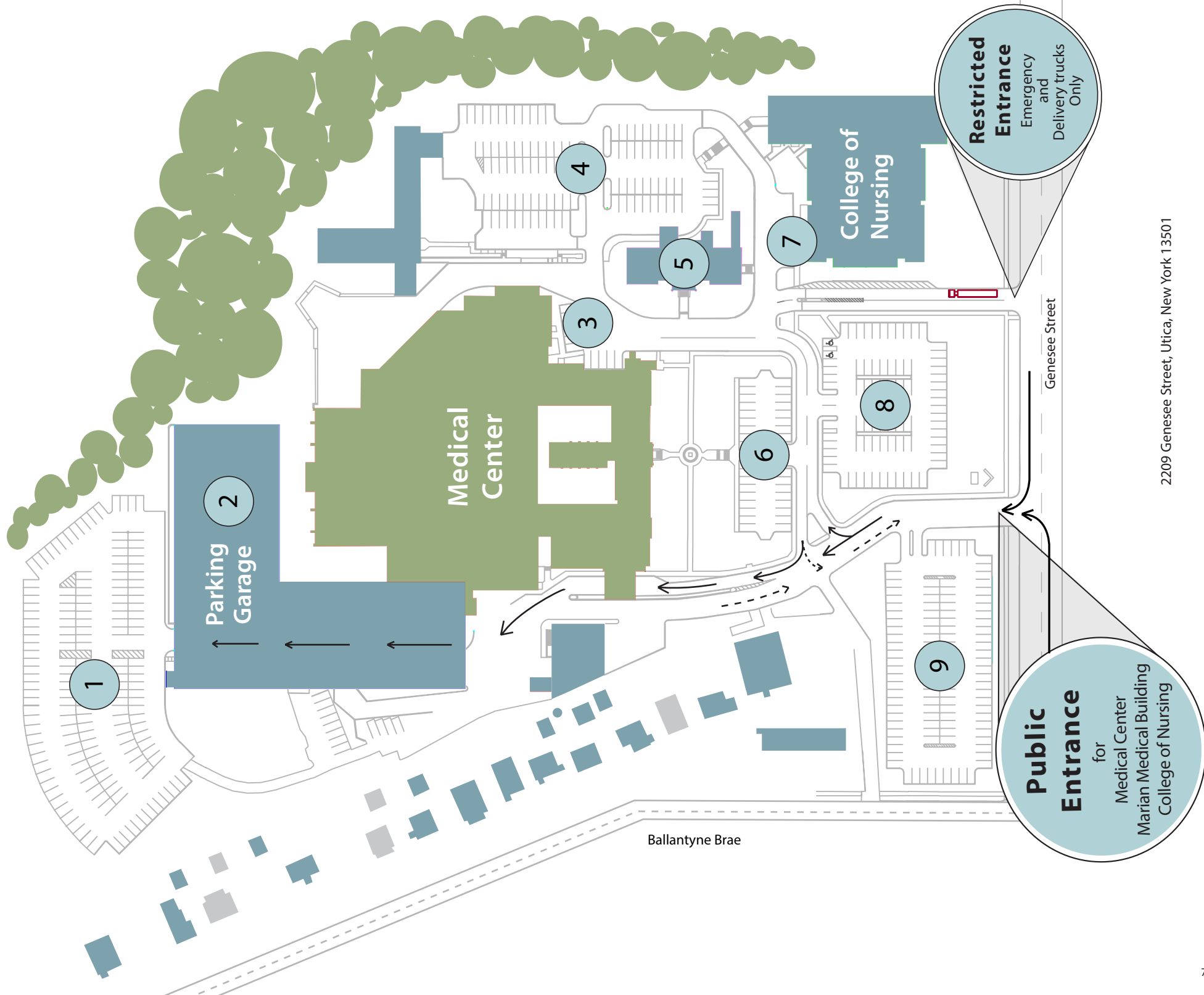

**We are a
smoke-free campus.
Please no smoking.**



2209 Genesee Street, Utica, New York 13501

VISITOR GUIDE

St. Elizabeth Campus



2209 GENESEE STREET, UTICA, NY
315-801-8100
MVHEALTHSYSTEM.ORG

Department/ Service

Level (Elevator closest to destination)

| | | | | | | | |
|--------------------------------|---------|---------------------------------------|---------|----------------------------------|---------|--------------------------------|---------|
| Acute Cardiac Care Unit (ACCU) | 2 (4,5) | Conference Rooms | 1 | Medical Records | 2 (4,5) | Psychiatry | 2 (8,9) |
| Admitting | 1 | Cardiothoracic Intensive Care (CTICU) | 4 (8,9) | MRI (CMI) | 1 | Inpatient Pulmonary | |
| Administration | 1 | Cardiothoracic Operating Room (CTOR) | 4 (1,2) | Neuro/Medical/Surgical | 3 (8,9) | Function Testing (PFT) | 3 (6,7) |
| Ambulatory Surgery Unit (ASU) | 4 (4,5) | Emergency Department (ED) | 1 | Nursing Administration | 1 | Rehabilitation Services | 2 (4,5) |
| Cafeteria | 1 | Gift Shop | 1 | Operating Room/ Recovery (OR) | 4 (4,5) | Special Care Unit (SCU) | 4 (4,5) |
| Cardiac Testing (CT) | 2 (4,5) | Intensive Care Unit (ICU) | 3 (4,5) | Orthopedic Unit | 2 (1,2) | Waiting Room - Medical Imaging | 1 |
| Cardiac Catheterization Lab | 2 (8,9) | Laboratory | 1 | Pre-Admission Testing (PAT) | 2 (6,7) | Waiting Room - Cath Lab | 2 (8,9) |
| Cashier | 1 | Medical Imaging | 1 | Post Anesthesia Care Unit (PACU) | 4 (4,5) | Waiting Room - Cardiac | 4 (8,9) |
| Chapel | 1 | Medical Library | 1 | Progressive Care Unit (PCU) | 4 (4,5) | Waiting Room - ICU | 3 (4,5) |
| | | | | | | Waiting Room - OR | 4 (4,5) |

Unit/Room Breakdown

| | Specialty | Room Number |
|-------|------------------------------------|------------------|
| 2A | Psychiatry Unit | 203-217 |
| 2D | Observation/ Medical/ Surgical | 219-230 |
| 2C | Acute Cardiac Care Unit | 251-260 |
| 2E | Orthopedic Unit | 261-272 |
| 3A | Medical/ Surgical | 301-312,321-326 |
| | Neuro/Medical/Surgical | 350-373 |
| 3C | Medical/ Surgical | 331-337,374-394 |
| CTICU | Cardiothoracic Intensive Care Unit | 401-409 |
| 4A | Progressive Care Unit | 410-413, 418-419 |
| 4C | Special Care Unit | 414-416,420-435 |
| ICU | Intensive Care Unit | 3001-3016 |

Key: Elevator  Entrance  Registration  Restroom  Stairs  Waiting Room 

First Level

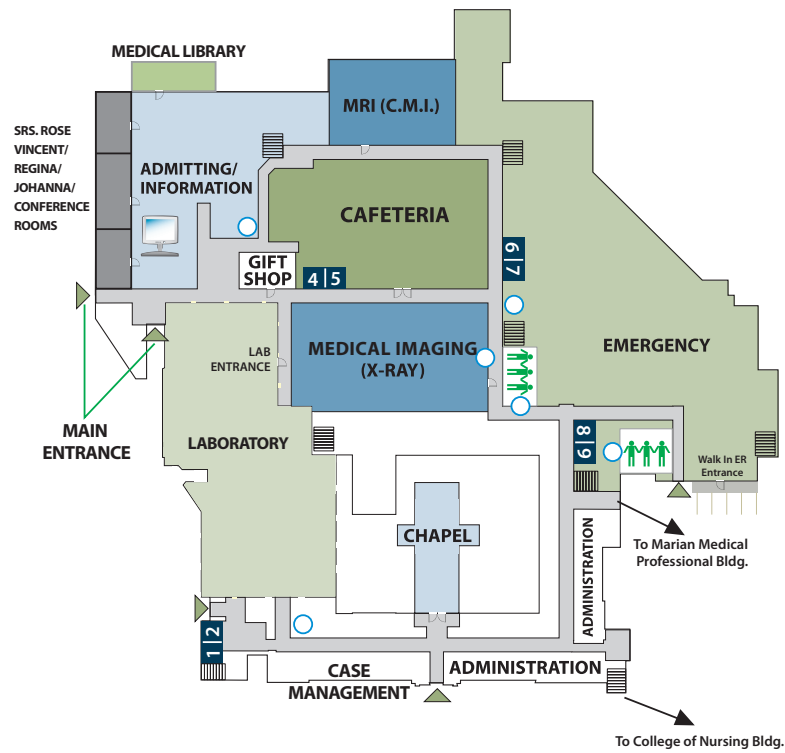

Second Level

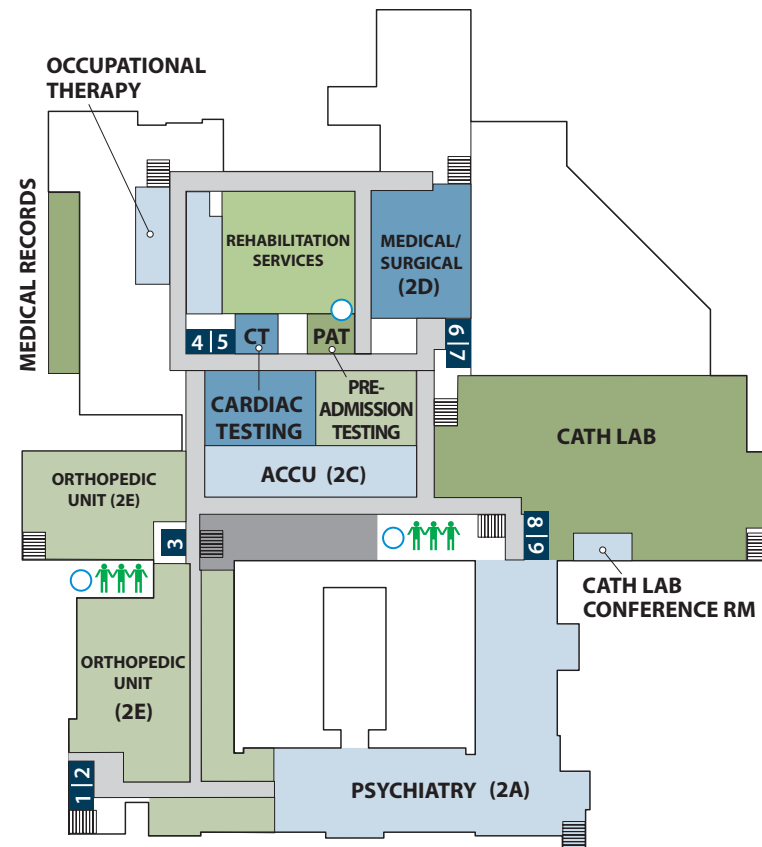

Third Level

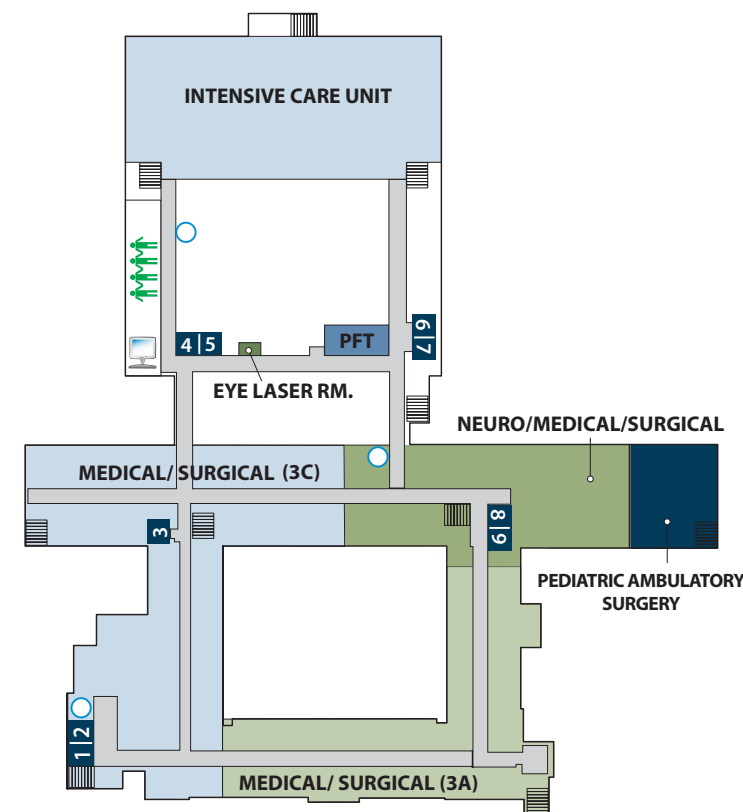

Fourth Level

